

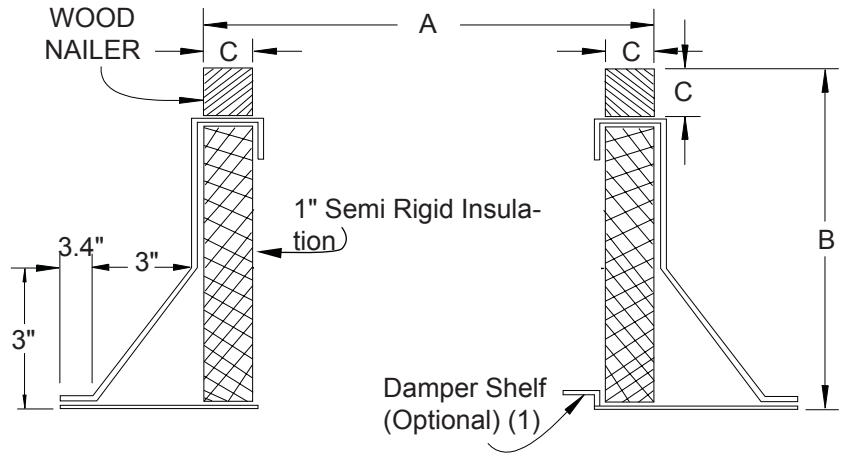

P: 800.961.7370
www.solerpalau-usa.com

INSULATED CANTED ROOF CURB FOR GRAVITY HOODS



"B" Curb Height - 12" STD

"C" Wood Nailer - 1 1/2" Sq

OPTIONS

1. Damper Shelf
2. Insulation retainers - solid or screen type
3. Burglar Bars - 1/2" diameter on 6" centers.
4. Finishes - baked or air-dried enamel or epoxy.
5. Heights: 8, 12, 16, 18, 20, 24" or special heights.
6. Single pitch or double pitch.
7. Aluminum construction.
8. Standard curb is "RF" roof over type. ("SF" available upon request)

Fan Size	Dimensions (in.)		
	RCXII Spun	RLX Louvered	Gravity Hoods BGH/AGH
4	-	Curb Cap minus 1 1/2"	Throat Size plus 7"
6	14 3/4		
8	14 3/4		
10	22 1/4		
12	22 1/4		
14	22 1/4		
15	-		
16	22 1/4		
18	27 3/4		
20	27 3/4		
24	33 3/4		
26	33 3/4		
30	40 3/4		
33	40 3/4		
36	40 3/4		
42	-		
48	-		

1. Damper shelf opening to be 1" less than damper size. Shelf must be specified if required.
2. All curbs are 18 gauge G-90 galvanized steel with continuous seams.
3. Curb extensions - add 1" to "A" dimension.

ROOF OPENING

Curb O.D. (A Dimension)
Less 3.25 inches

ACCESSORY ITEMS	1	2	3	4	5	ACCESSORY ITEMS	1	2	3	4	5
<input type="checkbox"/>						<input type="checkbox"/>					
<input type="checkbox"/>						<input type="checkbox"/>					
<input type="checkbox"/>						<input type="checkbox"/>					
<input type="checkbox"/>						<input type="checkbox"/>					
<input type="checkbox"/>						<input type="checkbox"/>					